

# GREEN & ENVIRONMENT AUDIT REPORT 2018 -19

Date 05/05/19 to 08.05.19

## **1. Aim & objective**

- a) Survey of pollution and environment of college campus.
- b) Practical education regarding pollution as the students of biological science
- c) Beautification of college campus.
- d) Cleanness in campus
- e) Continuous watch on waste management and pollution survey.
- f) Boosting plantation programme and gardening.

## **2. Location of the college**

Gopalpur College, Gopalpur, Balasore

Mouza- Sarangpur, Po-Jageswer pada

Via- Gopalpur, Ps- Khantapara, Dist- Balasore

State- Odisha

Plot no. 06- (1 acre) , Plot no-07 (81 decimal) and plot no- 1690,1691,1695,1696,1697

With total area -13.5 acre

Year of establishment 1978

## **3. Mode of survey**

- a) Pond- 90'x80'x6'
- b) General garden
- c) Greenies around pond

## **5. Study of Pollution**

- Chemistry lab- This lab conduct diff. Chemical Experiment and release for order containg  $so_2$   $cl_2$   $NH_3$   $(No)_x$   $co_2$  etc.
- A number of two wheelers comings to the collage daily. They release vehicular Exhaust
- BCR, GCR, SCR, office of this college release pungent odour having on  $H_3$ .
- A huge number of vehicles pass through the nearby salt roads which cause air pollution.

## 5. Other difficulties

- This college is very prone to cyclones, flood in each year. A number of plants are uprooted or dwindled.
- College is only 10 km away from seashore.
- A salt road passes close to the college. The vehicles release air pollutants which enter into college campus.

### Remedial measures

Waste management: - The official wastes like cartons, waste paper, fallen leaves, cow dung are collected and dumped into a pit. These are biologically degraded, the humus is collected and used in garden and Plantation.

### College Garden

To beautify the campus diff. Type of medicinal plants, flowering plant are planted. Seasonal flower are also planted in each season. The Permanent flowering plant are croton, Arcania, pasiflora, peniwinkle, henna, Jasmine, gardenia, chamap jasmine cucas, might jasmine, rose etc.

### Future plan

Different type of plant are to be planted around the play ground and in also in the campus of Subhadra ladies hostel.

### Appraisals repost

Audit is done by Eco club established in the Department of Botany. The durability or effectiveness of such report is one year in normal condition

**Green population study**

Name	Full grown	Young	Sapling	Uprooted	Total
Acacia	150	11	03	05	169
Bakul	21	29	-	-	50
Jamun	03	-	-	-	03
Sinisha	07	-	-	-	07
Betelnut	07	03	-	-	10
Paper plant	02	-	-	-	02
Neem	64	04	-	-	68
Kanchan	01	-	-	-	01
Sik Cotton	01	-	-	-	01
Radhachuda	12	01	-	-	13
Arjun	03	-	-	-	03
Batapi	00	01	-	-	01
Chhagalbati	-	-	-	01	01
Coconut	04	04	-	-	08
Red wood tree	08	-	-	-	08
Banyan	-	-	01	-	01
Jui	01	-	-	-	01
Mango	21	03	-	-	24
Sapota	09	-	-	-	09
Margosa	-	-	03	-	03
Champak	02	-	-	-	02
Nageswar	01	-	-	-	01
Debadaru	57	07	-	-	64
Guava	06	02	-	-	08
Muchakund	01	-	-	-	01
Tamarind	01	-	-	-	01
Janglibadam	01	-	-	-	01
Teak	40	-	32	-	72
Euqualiptes	11	-	-	-	11
Arcania	05	-	-	-	05
Palmyra palm	05	-	-	-	05
Prunus	-	03	-	-	03
Diospyros	01	-	-	-	01
Buanla	14	08	-	-	22
Karuna	01	-	-	-	01
Chachina	01	-	-	-	01
Travellens tree	02	-	-	-	02
Drum stick	01	-	-	-	01
Chinese box	01	-	-	-	01
Bhrusanga	01	-	-	-	01
<b>Total</b>	<b>461</b>	<b>74</b>	<b>39</b>	<b>06</b>	<b>589</b>

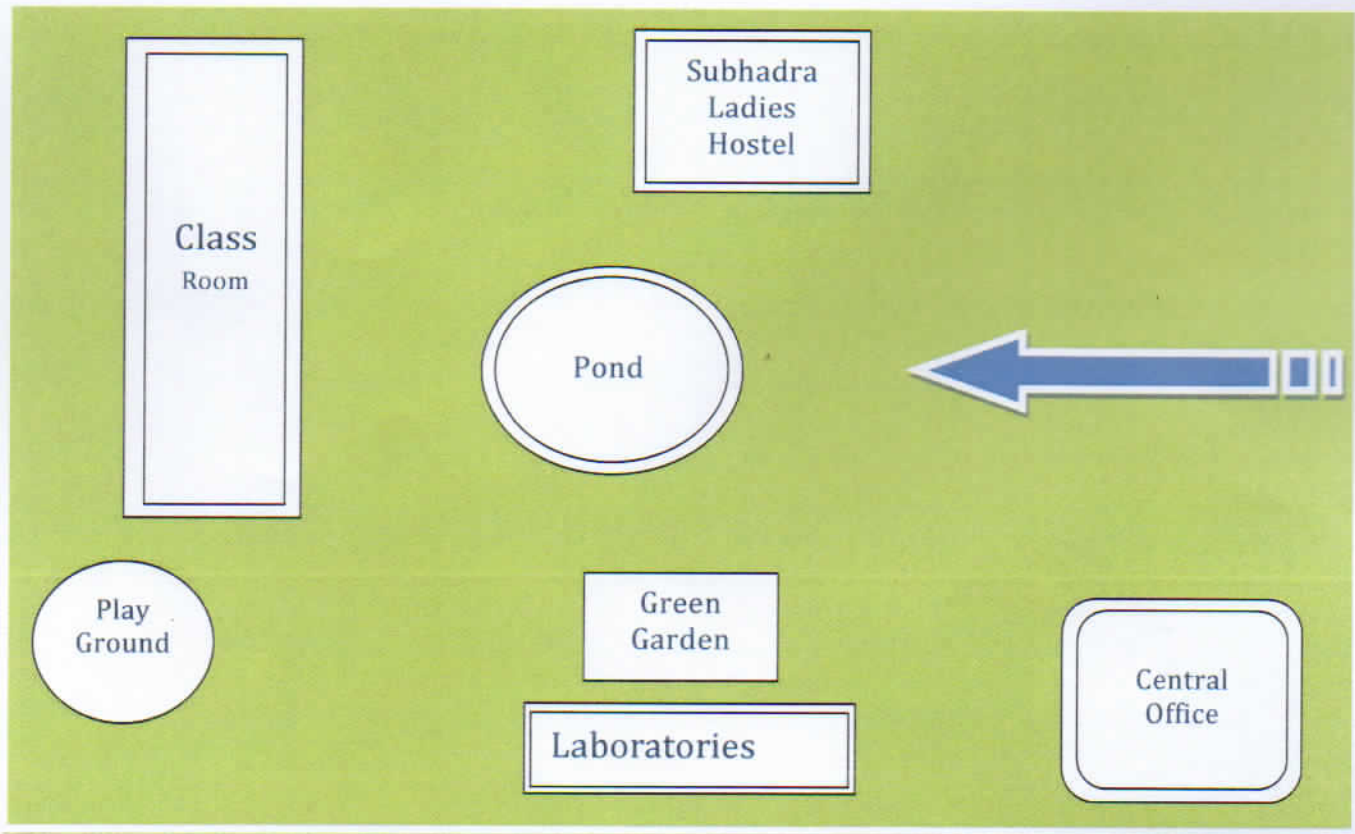

*Umesh Chandra Panigrahi*  
Signature of  
Green Audit Officer

*Nand Kishor Padhi*  
Principal  
02/05/19  
Gopalpur College, Gopalpur, Balasore  
Gopalpur College  
Gopalpur, Balasore.